

Smart Art Easy Butterfly

Lesson Plan (Ages 4+)





Easy Butterfly

Materials List:

- White Paper
- Coloured Crayon or Oil Pastels

STEPS

- Start from the bottom of the page, measure the width of three fingers to indicate where the ground will be and place a small dot.



- Repeat on the other side of the paper and connect the two dots to create a line. That line will be the ground.

Drawing the Larva

- Place your crayon/marker above the line and start by drawing one small circle at the very end of the paper.
- To create the rest of the body of the larva, draw a letter C connected to the first circle. Draw another letter C and connect it to the previous circle that you just drew (please refer to drawing guide below)

STEPS

- To draw the head, you will simply place the crayon on top of the last circle you drew and draw another small circle on top.
- On top of the head, you'll draw two parallel short lines pointing towards the edge of the paper. Optional choice, you can add two little dots for the eyes.

Drawing the Butterfly

- Start at the top of the page and draw a small circle.
- Place a small dot right above the head of the larva to indicate the size of the butterfly's body.





STEPS

- From the head, draw a long oval all the way to the dot you just placed
- From the top of the butterfly's head, draw two short, diagonal lines in opposite directions for the antenna
- On one end of the paper (right hand side) place a small dot that indicates how big the butterfly wing will be. Connect the dot to the body with a curved line (upside down smile). Repeat on the other side.
- From the very end of the curved line, draw a short, vertical line straight down on both sides. Look at the body, and find the middle point. On both sides of the body place a dot and connect it to the vertical line you just drew with another curved line (as if you are drawing a smile). Repeat on the opposite side.

STEPS

- Place one finger at the bottom and very edge of the butterfly wing, next to your finger place a small dot on the butterfly wing.
- From the mark you just placed, draw a vertical, curved line that connects to the body of the butterfly. Repeat on the other side.



Adding Details

- Details in the butterfly are simple. What we want to do is fill the butterfly wings with different types of patterns. You can draw small circles, wavy lines, zigzag lines, even hearts, get as creative as you want.

Smart Art

STEPS

Adding Colour

- When choosing colours for your butterfly, make sure you choose bright colours (pink, red, yellow, green, blue, orange, purple, turquoise)
- Carefully colour your butterfly, and larva, avoiding colouring over the black outline. If you happen to colour over the black outline, don't panic, simply continue colouring and try to be extra careful in the next section of your artwork.
- Using your crayons/markers, start adding fun details to your background. You can draw swirly lines or patterns or just colour in the background. Don't colour in the ground just yet.



STEPS

Colouring the Ground

- If you have crayons, select three different shades of the same colour (dark green, green and light green for example).
- 
- Start with the darkest colour and colour in the first part of the ground then the lighter colour and colour in another part of the ground. Finally, with your lightest colour, colour in the last part of the ground (the colour should be placed horizontally)
 - Get a white, clean tissue, and wrap it around one finger. With your finger and the tissue, start smudging the colours in an upwards direction. It will give you a grass like look. Add more colour and smudge as needed.

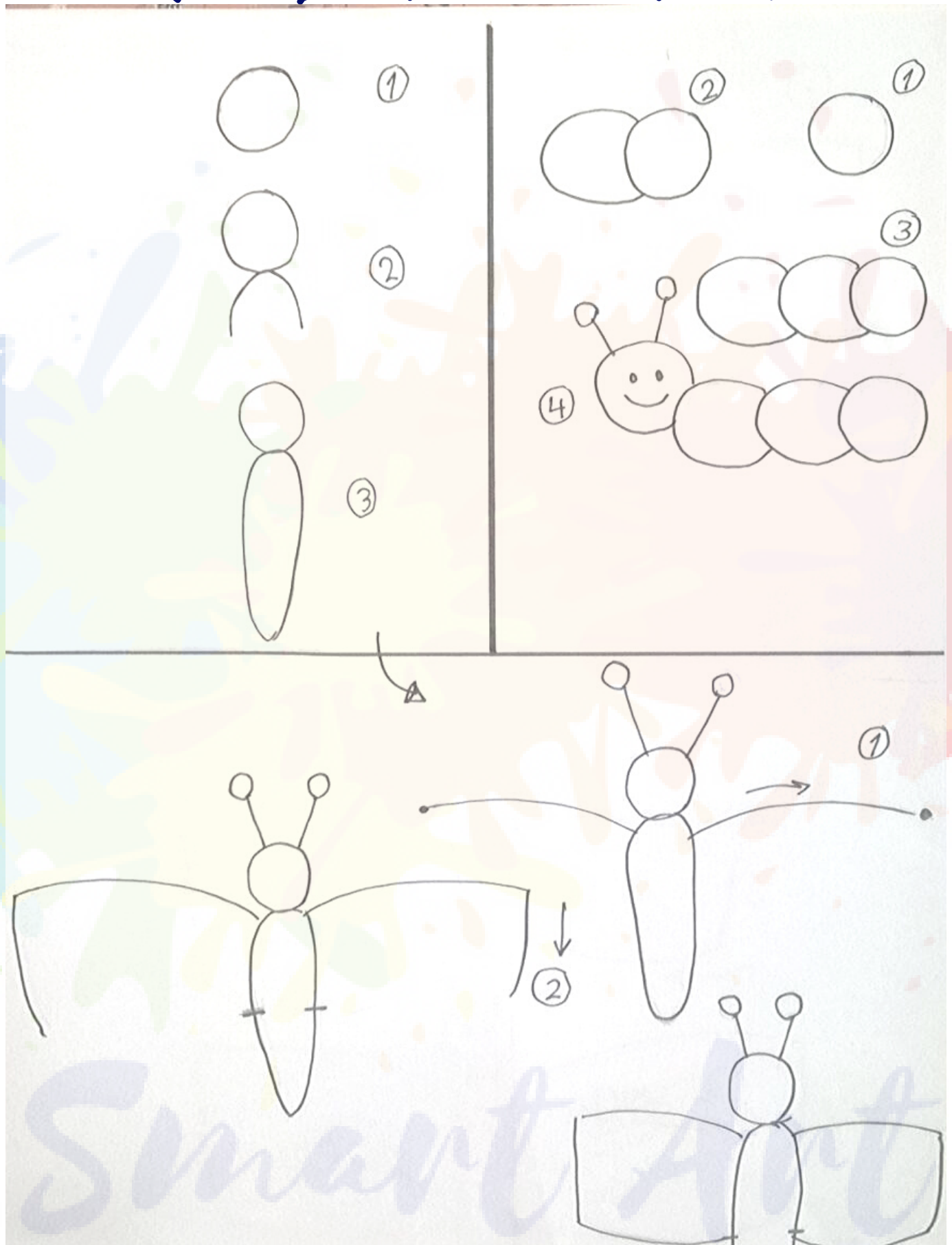

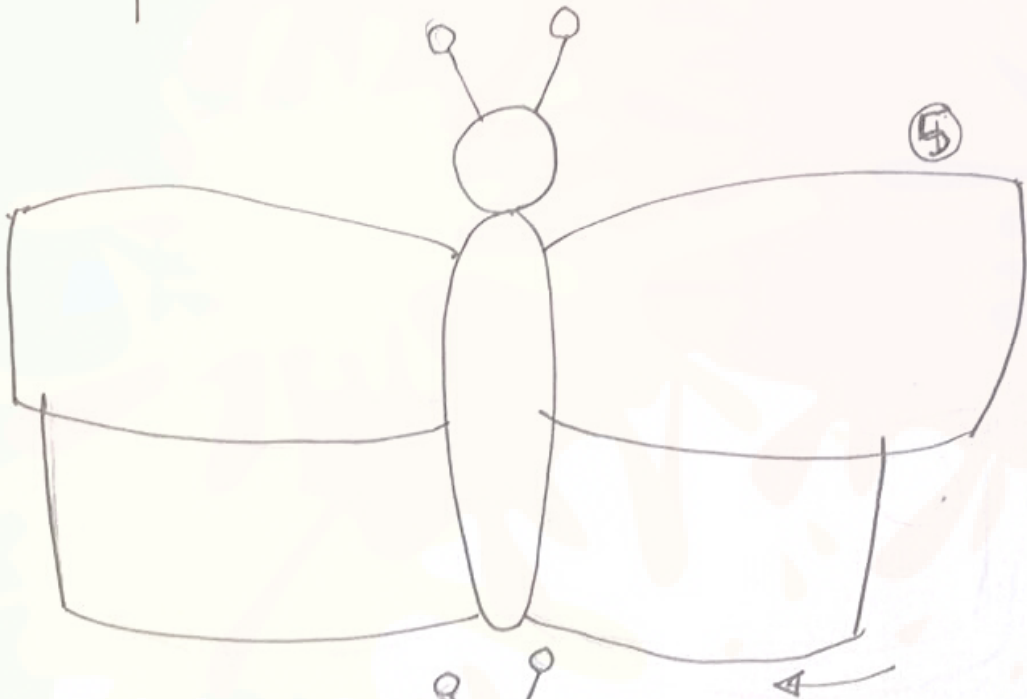

**5 Al Shareka Al Suisriah, Off Gazayer
Square, New Maadi, Cairo, Egypt
01010846025, 01019960994**

www.smartartegypt.net



Explore. Evolve.